

# TECHNICAL DATA SHEET 2410-2-2

Issue date: 05-2023

Page 1 from 3



Product name:	<b>DACO-KSU+</b> Self-adhesive polymer bitumen underlay membrane
Product code:	12340
Product standard:	EN 13707 EN 13969
Roll dimensions:	7.50 x 1.00 m
Protective coating: upper side bottom side	Film Release film seam and surface
Reinforcement:	Glass fibre
Product description:	Cold self-adhesive polymer bitumen membrane with glass fibre reinforcement as the bottom layer of roof insulation and cold self-adhesive polymer bitumen membrane with glass fibre reinforcement to seal buildings against rising damp and water.
Product use:	DACO-KSU+ is designed for use as a high performance underlay membrane, and is ideal for use within cold-applied roofing systems. Compatible with a wide range of substrates, the product is typically used within self-adhesive or torch-safe specifications and is compatible with DACO-KSO+ self-adhesive cap sheet.

Properties	Test method	Unit	Declared performance
Visible defects	EN 1850-1	-	no visible defects
Length	EN 1848-1	m	≥ 7.50
Width	EN 1848-1	m	≥ 1.00
Straightness	EN 1848-1	mm/10 m	< 20
Mass per unit area	EN 1849-1	kg/m <sup>2</sup>	unverifiable result
Thickness	EN 1849-1	mm	3.00 (-5/+10%)
Water tightness at 200 kPa	EN 1928 Method B	-	passed
Tensile properties: maximum tensile force	EN 12311-1	N	1000 / 1000 (+20; -0%)
Tensile properties: elongation	EN 12311-1	%	2 / 2 (+2; -0)
Flexibility at low temperatures	EN 1109	°C	≤ - 25
Flow resistance at elevated temperatures	EN 12311-1	°C	≥ +100

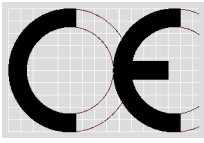

Properties	Test method	Unit	Declared performance
Reaction to fire	EN 11925-2	-	Class E according to DIN EN 13501-1
External fire performance	CEN/TS 1187	-	Broof (t4) (see tested system)

### Features & benefits:

- Flame free, self-adhesive application
- Excellent low temperature flexibility at -25°C
- Tough reinforcement
- SBS modified bitumen
- Versatile, long-lasting material

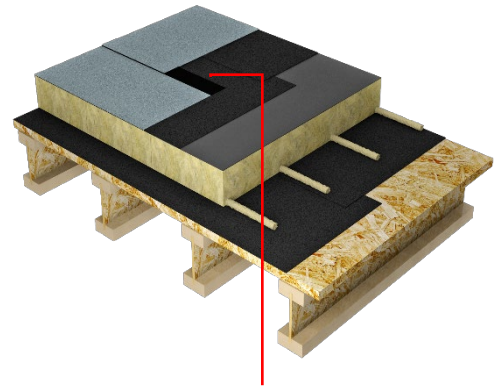

**DACO-KSU+**

### Application Overview:

DACO-KSU+ should be installed in accordance with manufacturer recommendations and all relevant national standards and codes of practice, including BS 8217: 2005 – the code of practice for reinforced bitumen membranes for roofing.

In order to fit the membrane properly, the surface has to be dry, free of oil, fat and dust and other impurities. The membrane, which is produced with two separator strips on its underside is glued on by removing of the separator foil strips while rolling out the membrane onto the rigid foam or with Primer prepared surface. The membrane has to be applied with an 8 cm joint overlap.

The integrated safety seal edge of the longitudinal seam has to be closed with a hot air blow dryer (>3000 W) or activated thermally with hot gas. All joint overlaps have to be rolled out with a draw roll. The outside, surface and temperature of the material during the application must be at least + 5°C.

Following the application of DACO-KSU+ as part of a multi-layer sealing construction, the consecutive layer/top sheet has to be immediately torched on over the complete surface. Should it not be possible to apply the consecutive layers immediately then the overlaps of the DACO-KSU+ need to be thermally activated and pressed down thoroughly. The final bonding of DACO-KSU+ to the surface is achieved by torching on the next sealing layer.

To prevent thermal changes to the shape of the EPS insulation boards, excessive heating of the top of the DACO-KSU+ has to be avoided when torching on the next layer.

When using the membrane as part of a temporary or provisional roof construction the joint overlap has to be activated thermally (e.g. with hot gas or hot air).

### Chemical Resistance:

DACO-KSU+ is water-resistant as well as resistant to watery solutions of salt, diluted non-oxidising acids and bases. Aliphatic and aromatic hydrocarbons as well as chlorine hydrocarbons, oils and greases loosen DACO-KSU+.

### Storage:

Store upright in a cool and dry place.

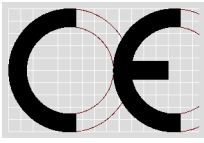

## TECHNICAL DATA SHEET 2410-2-2

Issue date: 05-2023

Page 3 from 3



### Health & safety:

Health and Safety should be observed at all times in accordance with HSE and industry guidance. Specific Risk Assessments and Method Statements should be produced by contractors where necessary to ensure Working at Heights, Fire Safety and Manual Handling rules are compliant with current law and regulations. Health and safety data sheets are available for all materials on request from GEORG BÖRNER Technical Service Department.

### Certification number:

1724 - CPR - 041101

1724 - CPR – 041201